

GN 162.3 | Connecting clamp bases

Aluminium



- 1
- 2
- 3
- 4
- 5
- 6
- 7
- 8
- 9
- 10
- 11
- 12
- 13
- 14
- 15
- 16
- 17
- 18

MATERIAL

Aluminium, matte finish.
AISI 304 stainless steel screw and nut.

STANDARD EXECUTIONS

Surface finish index:
- **BL**: natural colour.
- **SW**: epoxy resin coating resistant to UV rays, RAL 9005 black colour.

FEATURES AND APPLICATIONS

The assembly hole of GN 162.3 connecting clamps allows an excellent match with tubes GN 990 (see page 1368).
The clamping screw d3 may be replaced by clamping kit GN 911 (see page 1372).

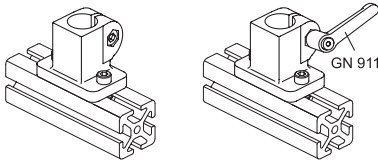

Conversion Table 1 mm = 0.039 inch	
d1	
mm	inch
10	0.39
12	0.47
14	0.55
15	0.59
16	0.63
18	0.71

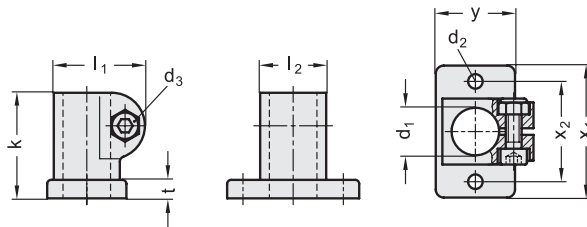

Connecting clamps

Code BL	Code SW	Description	d1	d2	d3	k	l1	l2	t	x1	x2	y	d3 Clamping kit	⚖️
GN.48305	GN.48307	GN 162.3-B10-2-*	10	5.5	M6	40	34.5	25	7	50	38	30	GN 911-M6-22	96
GN.48315	GN.48317	GN 162.3-B12-2-*	12	5.5	M6	40	34.5	25	7	50	38	30	GN 911-M6-22	92
GN.48325	GN.48327	GN 162.3-B14-2-*	14	5.5	M6	40	34.5	25	7	50	38	30	GN 911-M6-22	88
GN.48335	GN.48337	GN 162.3-B15-2-*	15	5.5	M6	40	34.5	25	7	50	38	30	GN 911-M6-22	86
GN.48345	GN.48347	GN 162.3-B16-2-*	16	5.5	M6	40	34.5	25	7	50	38	30	GN 911-M6-22	84
GN.48355	GN.48357	GN 162.3-B18-2-*	18	5.5	M6	40	34.5	25	7	50	38	30	GN 911-M6-22	79

2

* Complete the description of the standard item needed by adding the finish of the connector clamps: BL (blank) or SW (black).